



Key Largo Fire Pit

Installation Instructions for Key Largo, all base materials and top styles.



Contents

Required Tools.....2

Assembly Instructions.....3

Igniter Installation4

Gas Connection.....5

Locating Propane tank.....5

Gas Line Location.....6

Finishing Touches.....6

Warranty Information.....8

Required Tools



- **Utility Knife**
To cut and remove packaging



- **2 Open Ended Wrenches**
To make gas connections



- **Leather Gloves**
To protect hands from rough edges found on the coffee table.



- **One (1) AAA Battery (not included)**
Required for piezoelectric igniter installation.



- **It is recommended that a minimum of two people assemble and install fire pit tables.**

Assembly Instructions

1. Remove access door from packaging
2. Remove all components from packaging.
3. Move the base without door to desired location and set into place.
4. When locating your coffee table, refer to the Crystal Fire manual and maintain clearance to combustibles.
5. Assemble as shown below.

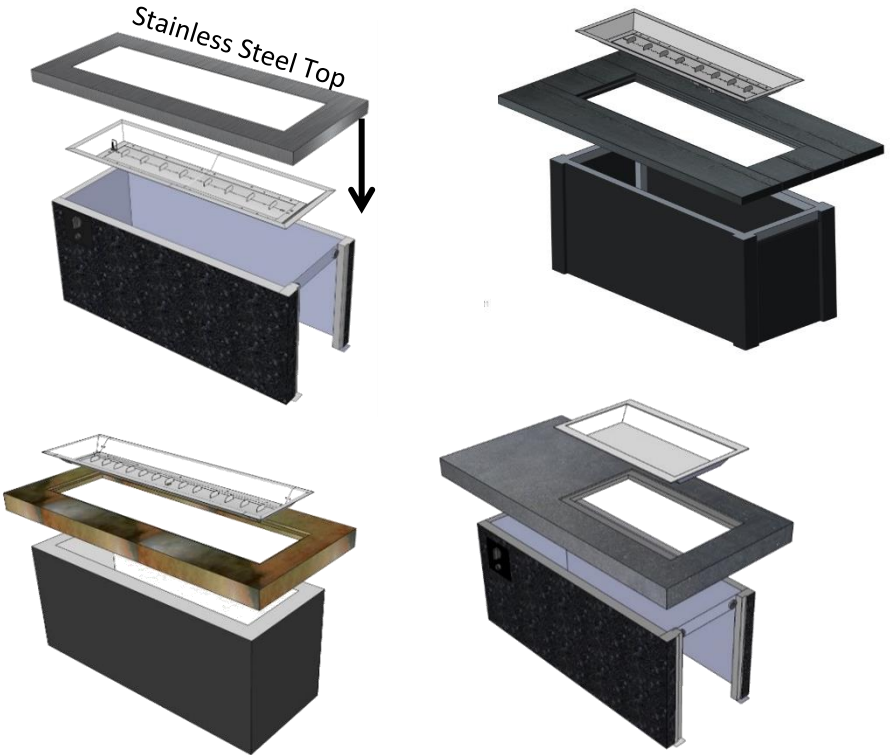

*Base colors and materials may differ depending on model

Igniter Installation

1. Sparker must be installed before burner valve.
2. Unscrew sparker cap and hex nut. Install as shown below.

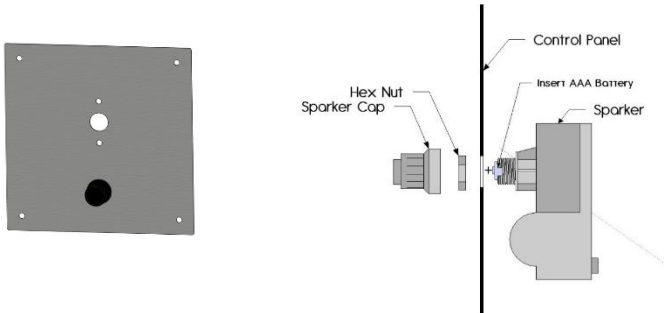

3. To properly install ignition system, a spark and ground wire need to be attached to the igniter box.
 - Plug both black wires hanging from the bottom of the burner into the sparker box.

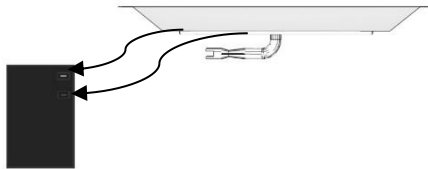

- Test system by pushing the button on the ignitor, look and listen for a solid spark at the electrode on the burner surface. Consult troubleshooting section if spark is faint or intermittent.
4. Once ignition system is grounded and gas connections are secured and checked for leaks, set the burner back into its original position and replace the top if applicable.

Gas Connection

Read and understand your Crystal Fire Plus owner's manual before beginning burner hookups or using the device.

1. See Crystal Fire Plus instructions for burner installation.
 - All Gas connections were completed at the factory.
2. Check all connections for leaks. If needed, tighten connection with 2 wrenches and re-check for leaks.

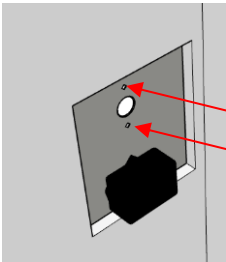

Attach burner valve to control panel with provided screws

Locating your Tank

1. Tilt your propane tank into the slide out tank drawer.

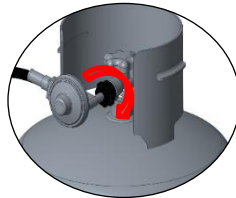
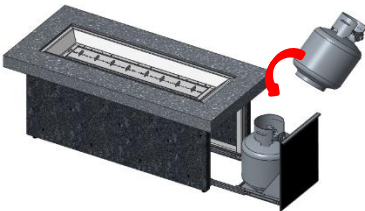

2. With the propane tank and control valve in the OFF position, connect the Regulator Hose, included with the Crystal Fire Plus Burner, to your propane tank (not included). Hand tighten connection, do not use tools to tighten this connection.
3. Slide tank drawer in. Ensure that the Gas hose does not get pinched in the process of sliding the tank drawer.

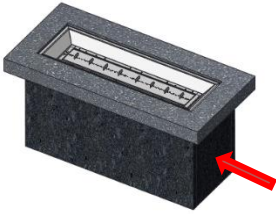

NOTE: Over time the bearings in the door glides may require re-greasing. Any spray lubricant, such as WD-40, may be used to lubricate drawer glides. Perform annually or on an as needed basis to maintain smooth operation.

Gas Line Location

If the fire pit is to be supplied by natural gas or a hard piped propane system, locate your plumbing outside of the area of the tank drawer. Gas can be stubbed up within the green area indicated below.

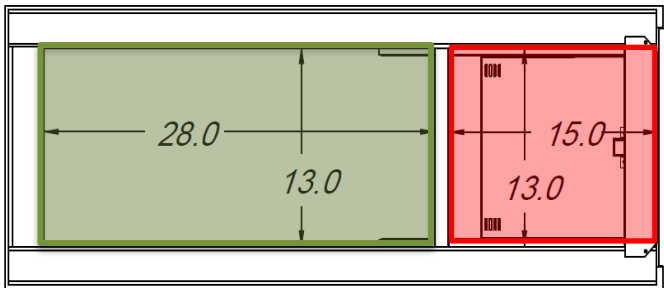

Finishing touches

Once fire pit is set up and in the desired position, scatter decorative glass on burner surface forming an even layer of beads.

**DO NOT BURN WITHOUT GLASS OR OTHER
APPROVED DECORATIVE FIRE MEDIA**

DO NOT BURN WITH GLASS COVER INSTALLED

IMPORTANT

Please consult your Crystal Fire Plus instruction manual for detailed instructions and important information related to hooking up your linear burner, including safety information, proper tightening of connections with two wrenches and full burner setup and lighting instructions.

**DO NOT ATTEMPT TO INSTALL CFP1242 or CFP1224 BURNER
WITHOUT FIRST CONSULTING THE CRYSTAL FIRE OWNER'S MANUAL.**

WARNING

After consulting the manual and following instructions, remember; before operating, all gas connections must be fully checked for leaks



WARNING: This product can expose you to chemicals including Carbon Monoxide and Benzene which are known to the State of California to cause cancer or birth defects or reproductive harm. For more information, visit www.P65Warnings.ca.gov

Thank you for purchasing an Outdoor GreatRoom Company product! This fire pit was made with pride in the USA.

Warranty: Fire pit tables are covered under a 1-year manufacturer's warranty. Please visit <http://www.outdoorrooms.com/warranty-form> to register your product.



© 2014 The Outdoor GreatRoom Company

14400 Southcross Drive West • Suite 100 • Burnsville, MN 55306
Toll Free: 1-866-303-4028 • Sales@OutdoorRooms.com